

YPT系列 变频调速三相异步电动机

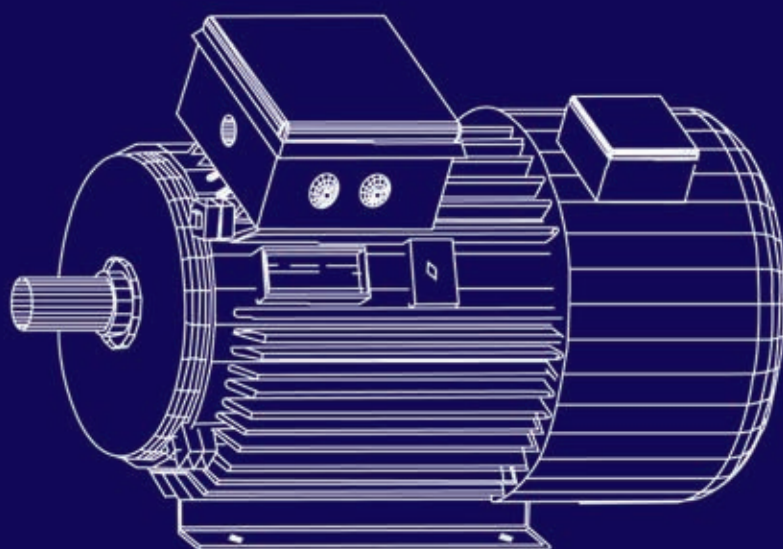

佳木斯防爆电机有限公司
JIAMUSI EXPLOSION-PROOF ELECTRIC MOTOR CO.,LTD

概 述

YPT系列鼠笼型变频调速三相异步电动机，是我公司吸取国内外同类电机之优点并采用计算机优化设计研制而成的新产品。

YPT系列电机调频性能好、节能、起动转矩性能好、噪声低、振动小、运行安全可靠、外形美观。功率等级和安装尺寸完全符合国际电工委员会（IEC）标准。本系列电动机采用F级绝缘，外壳防护等级为IP54、IP55，工作方式为S1。

General

YPT series of variable-frequency adjustable-speed three-phase induction squirrel cage motors are the new products which our company have developed by drawing the merits of the same motors at home and abroad and using the computer optimum design.

speed three-phase induction squirrel cage motors are the new products which our company have developed by drawing the merits of the same motors at home and abroad and using the computer optimum design.

This series motors have the advantages of good adjustable-frequency performance, saving energy, satisfactory starting torque characteristic, lower noise, small vibration, higher safety and reliability in operation, and beautiful appearance, etc. Rated outputs

电动机型号说明：

Meaning of type of motor:

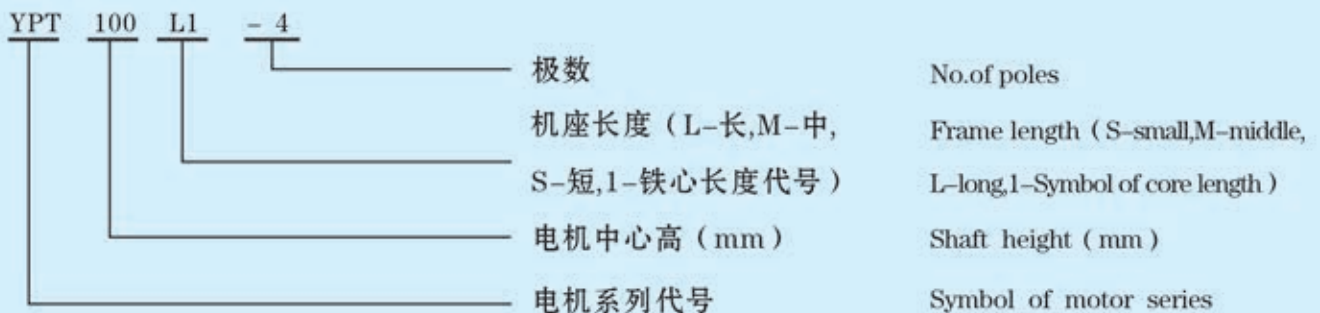

使用条件

海拔 ≤ 1000m
环境温度 ≤ 40℃
相对湿度 ≤ 90%

Operation conditions

Attitude above sea level: up to 1000m.
Ambient temperature dose not exceed 40℃
Relative humidity is not more than 90%.

结构简介

YPT系列电动机采用计算机辅助设计技术，为使电动机能适应SPWM及PWM变频电源供电的状况，在设计上对定子、转子槽形和定子绕组分布形式作了特殊考虑，以期获得一个

Brief introduction of construction

CAD technique has been applied during the motors design. In order to accommodate the motor to SPWM and PWM fed power supply, slot shapes of stator and rotor and stator winding distribution are specially considered, so as to obtain a suitable inductance value to suppress and reduce the harmful effect caused by the harmonics and their associated high-or-

较为合适的电感值，来抑制和减少谐波所产生的不良影响。

电动机的电磁负荷设计考虑了一定的裕度，既能保证电动机在高频时的过载能力又能在低频运行时保持恒转矩输出。此外电动机绝缘系统采用了目前国际上广为使用的F级绝缘系统，绝缘可靠、性能优良。在结构设计方面，安装尺寸与Y2系列相同，便于用户配套使用。

电动机采用独立通风的冷却结构，在非轴伸端设独立的轴向风机强迫通风，效率高、噪声低、结构简单、便于安装编码器、测速机及制动器等辅助设备，保证了电动机在低速运行时温升不超过限值。

用 途

本系列电动机适用于各种需要调速传动装置中，广泛应用于轻工、纺织、化工、石油、冶金、机床、水泵等行业，配合高精度传感器可实现高精度闭环运行。

结 构 型 式

电动机的外壳防护等级为IP54,也可按用户需要制造。

电动机的冷却方式为独立风机冷却（IC416）,也可按需要制成其它冷却方式。

电动机的结构及安装型式为IMB3、IMB5、IMB6、IMB7、IMB35、IMV1、IMV3、IMV5、IMV6、IMV15、IMV36。

如用户对测温、润滑、测速、制动器等有特殊要求时可特殊设计。

配套冷却风机 matching cooling fan

电机机座号 Framesize	80	90	100	112	132	160	180	200	225	250	280	315	355	400
风机功率 Output of fan (W)	60	60	60	60	60	60	60	230	230	230	450	550	1100	1800
风机电压 Voetage of fan	380V三相							380V Three-phase						

der harmonics.

Electromagnetic load design of motor allows for a certain margine. This could not only ensure overload capacity of motors at high-frequency but also keep constant-torque output in low-frequency operation. Furfermore, insultaion system of motor is a class F insulation system widely used in internationally at present. Insulation is reliable and its performance is satisfactory. For construction design, mounting dimensions of motors are the same as Y2 range to be convenient to select them.

The motors have the sparately ventilated cooling construction. Separated axial fan are located on the outer shaft extension end to achieve forced-ventilation. The motors have the higher efficiency and lower noise, simple construction, and are easy to fit the auxiliary equipments such as encoder, techogenerator, brake, etc. This fan assure that the temperature rise of motors at a low speed operation does not exceed limiting value.

Application

This series of motors are used for various drives which require speed adjustment. They are widely used in light-industry, textile, chenical, petroleum, metallurgical, machine tool, water pump industries, etc. They, in conjunction with high-precision sensor, can achieve high precision closed-loop operation.

Type of construction

Degree of protection by motor enclosre is IP54, but can also be available on customer request.

The cooling form of motor is separatc-fan cooled (IC416). The other cooling forms can also be available on customer request.

The basic mounting arrangements are IMB3, IMB5, IMB6, IMB7, IMB35, IMV1, IMV3, IMV5, IMV6, IMV15, IMV36.

If cust special requirements with respect to temperature measurement, lubrication, speed measurement and brake, etc. the motors can specially be designed.

接线盒

从轴伸端视之，80-400机座号电机的接线盒位于电动机顶部。

主要技术性能特点

电动机为连续工作制(S1)。

电动机的额定电压为380V，额定频率为50Hz，也可根据用户要求设计其它额定点的电压和频率。电动机的绝缘等级为F级，绝缘结构具有耐高次谐波冲击能力。

电动机调速范围广，2极电机及355-400机座号变频范围为3-60Hz，4极及以上变频范围为3-100Hz，低于额定频率以下为恒转矩输出，高于额定频率以上为恒功率输出，在矢量控制的条件下，调速范围还可扩大。

过载能力强。能够承受额定转矩的160%过载，历时1min。

低速性能好。低速时转矩平滑，无爬行现象。

电动机的接线方式，3kW及以下为Y接，4kW及以上为 Δ 接。

定货须知

本样本仅供用户选型用，具体数据容有变动。

定货时请注明电动机型号、额定功率、额定电压、额定频率、调频范围、安装型式及安装尺寸。

若对电机极数、电压等级、调速特性、绝缘等级、安装尺寸等有特殊要求，请在定货时说明。

Terminal box

Terminal boxes are located on the righthand side the motors of frame sizes 80 to 400 as viewed from the top of the motor.

Main technical performances

Duty type of motor is continuous(SI).

Rated voltage of motors is 380V, rated frequency is 50 Hz. The motors can also be designed with voltages and frequencies at other rated point on customer tequest.

The motors are class F insulated, insulation structure has a capability of withstand the highorder harmonic surge. Adjustable-speed range of motors is wide. For 2-pole motors and frame size H355to400-pole motors, variable-frequency range is 3 to 60Hz. For the motors with Nos. of pole 4 or more, it is 3 to 100Hz. Motors have constant-torque output when frequency of motors is lower than rated one and have constant-power output when frequency of motors is higher than rated one. Under the Vector control conditions, adjustable-speed range can also be enlarged.

Overload capacity of motor is higher. The motors can withstand 160% of rated torque for one minute.

The motors have a good operation performance at low-speed. They have smooth torque during a low-speed operation and have not ctawling phenomenon.

Motors is Y-connected for below 3kW and is Δ connected for 4kW or more.

Ordering information

This catalog is for selection of motors by customer only, specific data are subject to change withoutn o-tice.

When ordering, specify the motor type, output, rated voltage, rated frequency, adjustment-frequency range, mounting arrangement and mounting dimensions.

If you have special tequirements for No. of, poles, voltage class, sdjustment-spped characteristic, insulation class, mounting dimensions, etc. please specity in details in ordering.

技术数据 Technical data

型号 Type of motor	功率 Rated Output (kw)	额定转速 Rated speed (r/min)	额定电流 Rated current (A)	额定效率 Rated Efficiency (%)	额定功率因数 Rated power factor (cosΦ)	额定转矩 Rated torque	最大转矩 额定转矩 Breakdown torque Rated torque	重量 Weight (kg)	
同步转速3000r/min Synchronous speed3000r/min 50Hz									
80M1-2	0.75	2830	1.83	75	0.83	2.5	2.3	17	
80M2-2	1.1	2830	2.6	77	0.84	3.7		18	
90S-2	1.5	2840	3.46	79	0.84	5.0		22	
90L-2	2.2	2840	4.86	81	0.85	7.4		26	
100L-2	3.0	2870	6.34	83	0.87	9.9		35	
112M-2	4.0	2890	8.2	85	0.88	13.2		45	
132S1-2	5.5	2900	11.1	86	0.88	18.1		67	
132S2-2	7.5	2900	14.9	87	0.88	24.7		71	
160M1-2	11	2930	21.3	88	0.89	35.8		118	
160M2-2	15	2930	28.8	89	0.89	48.9		128	
160L-2	18.5	2930	34.7	90	0.90	60.3		150	
180M-2	22	2940	41.0	90	0.90	71.5		178	
200L1-2	30	2950	55.5	91.2	0.90	97.1		230	
200L2-2	37	2950	67.9	92	0.90	119.8		250	
225M-2	45	2970	82.1	92.3	0.90	144.7		319	
250M-2	55	2970	99.8	92.5	0.90	176.9		403	
280S-2	75	2970	135.3	93	0.90	241.2		549	
280M-2	90	2970	160.2	93.8	0.91	289.4		595	
315S-2	110	2980	195.4	94	0.91	352.5		980	
315M-2	132	2980	233.2	94.5	0.91	423.0		1050	
315L1-2	160	2980	282.4	94.6	0.92	512.7		1100	
315L2-2	200	2980	348.4	94.8	0.92	640.9		1170	
355S1-2	(185)	2980	323	94.6	0.92	592.8		1420	
355S2-2	(200)	2980	348	94.8	0.92	640.9		1490	
355M1-2	(220)	2980	383.3	94.8	0.92	705.0		1550	
355M2-2	250	2980	433.7	95.3	0.92	801.2		1630	
355L1-2	(280)	2980	485	95.3	0.92	897.3		1775	
355L2-2	315	2980	545.3	95.6	0.92	1009.4		1900	
400S-2	355	2984	604	96	0.93	1136.1		2189	
400M-2	400	2984	681	96	0.93	1380.2		2389	
同步转速 1500 r/min Synchronous speed 1500 r/min 50Hz									
80M1-4	0.55	1390	1.57	71	0.75	3.8		2.2	17
802-4	0.75	1390	2.1	73	0.76	5.1			18
90S-4	1.1	1400	2.85	75	0.77	7.5	23		
90L-4	1.5	1400	3.72	78	0.79	10.2	27		
100L1-4	2.2	1430	5.1	80	0.81	14.7	35		
100L2-4	3.0	1430	6.71	82	0.82	20.0	38		
112M-4	4.0	1440	8.8	84	0.82	26.5	49		
132S-4	5.5	1440	11.7	85	0.83	36.5	67		
132M-4	7.5	1440	15.6	87	0.84	49.7	80		
160M-4	11	1460	22.5	88	0.84	71.9	124		
160L-4	15	1460	30.0	89	0.85	98.1	147		

注：带（）为不推荐规格。 Note: The date with '（）' are not Yecommauded specifications.

技术数据 Technical data

型号 Type of motor	功率 Rated Output (kw)	额定转速 Rated speed (r/min)	额定电流 Rated current (A)	额定效率 Rated Efficiency (%)	额定功率因数 Rated power factor (cos Φ)	额定转矩 Rated torque	最大转矩 额定转矩 Breakdown torque Rated corque	重量 Weight (kg)
		同步转速 1500 r/min		Synchronous speed 1500r/min				
180M-4	18.5	1470	36.4	90.5	0.86	120.1	2.2	173
180L-4	22	1470	42.9	91	0.86	142.9		197
200L-4	30	1470	58.0	92	0.86	194.9		255
225S-4	37	1480	70.2	92.5	0.87	238.7		305
225M-4	45	1480	85.0	92.8	0.87	290.4		333
250M-4	55	1480	103.2	93	0.87	354.4		400
280S-4	75	1480	138.4	93.8	0.87	483.9		560
280M-4	90	1480	165.5	94.2	0.87	580.7		660
315S-4	110	1480	201	94.5	0.88	709.8		1000
315M-4	132	1490	240.4	94.8	0.88	846.0		1100
315L1-4	160	1490	287.8	94.9	0.89	1025.5		1140
315L2-4	200	1490	359.8	95	0.89	1281.8		1220
355S1-4	(185)	1480	329	94.9	0.89	1193.7		1695
355S2-4	(200)	1480	355	94.9	0.89	1290.5		1738
355M1-4	(220)	1480	395.8	94.9	0.89	1419.5		1820
355M2-4	250	1480	443.3	95	0.90	1613.1		1890
355L1-4	(280)	1480	496.5	95.5	0.90	1806.7		2095
355L2-4	315	1480	558.6	95.6	0.90	2032.0		2180
400S-4	355	1487	628	95.5	0.90	2279.9		2345
400M-4	400	1487	707	95.5	0.90	2568.9		2502
400L-4	450	1487	795	95.5	0.90	2890	2554	
		同步转速 1000 r/min		Synchronous speed 1000 r/min				
90S-6	0.75	910	2.3	69	0.72	7.9	2.1	25
90L-6	1.1	910	3.2	72	0.73	11.5		27
100L-6	1.5	940	4.0	76	0.76	15.23		32
112M-6	2.2	940	5.6	79	0.76	22.3		45
132S-6	3.0	960	7.4	81	0.76	29.8		65
132M1-6	4.0	960	9.8	82	0.76	39.8		75
132M2-6	5.5	960	12.9	84	0.77	54.7		84
160M-6	7.5	970	17.2	86	0.77	73.8		121
160L-6	11	970	24.5	87.5	0.78	108.3		146
180L-6	15	970	31.7	89	0.81	147.7		186
200L1-6	18.5	970	38.6	90	0.81	182.1		235
200L2-6	22	970	44.8	90	0.83	216.6		260
225M-6	30	980	59.3	91.5	0.84	292.2		302
250M-6	37	980	71.1	92	0.86	360.5		400
280S-6	45	980	86.0	92.5	0.86	438.5		533
280M-6	55	980	104.7	92.8	0.86	536.0		590
315S-6	75	990	141.7	93.5	0.86	723.5		990
315M-6	90	990	169.5	93.8	0.86	868.2		1015

注：带（）为不推荐规格。 Note: The data with '（）' are not recommended specifications.

技术数据 Technical data

型号 Type of motor	功率 Rated Output (kw)	额定转速 Rated speed (r/min)	额定电流 Rated current (A)	额定效率 Rated Efficiency (%)	额定功率因数 Rated power factor (cosΦ)	额定转矩 Rated torque	最大转矩 Breakdown torque 额定转矩 Rated torque	重量 Weight (kg)	
同步转速 1000 r/min Synchronous speed 1000 r/min 50Hz									
315L1-6	110	980	206.8	94	0.86	1061.1	2.1	1110	
315L2-6	132	980	244.7	94.2	0.87	1273.3		1190	
355S-6	160	980	292.3	94.5	0.88	1559.1		1690	
355M1-6	(185)	980	338	94.5	0.88	1802.8		1740	
355M2-6	200	980	365.4	94.7	0.88	1949.0		1820	
355L1-6	(220)	980	402	94.7	0.88	2143.8		1910	
355L2-6	250	980	456.8	94.9	0.88	2436.2		2120	
400S-6	380	993	509	95	0.88	2692.8	2.2	2459	
400M-6	315	992	573	95	0.88	3037.5		2522	
400L-6	355	992	645	95	0.88	3417.6		2589	
同步转速 750 r/min Synchronous speed 750 r/min 50Hz									
132S-8	2.2	710	6.16	78	0.71	29.6	2.0	64	
132M-8	3.0	710	8.06	79	0.73	40.3		75	
160M1-8	4.0	720	10.3	81	0.73	53.1		110	
160M2-8	5.5	720	13.6	83	0.74	72.9		121	
160L-8	7.5	720	17.8	85.5	0.75	99.5		147	
180L-8	11	730	25.5	87.5	0.76	143.9		182	
200L-8	15	730	34.1	88	0.76	196.2		290	
225S-8	18.5	730	41.1	90	0.76	242.0		275	
225M-8	22	740	47.4	90.5	0.78	283.9		307	
250M-8	30	740	64.2	91	0.79	387.1		522	
280S-8	37	740	77.8	91.5	0.79	477.5		522	
280M-8	45	740	94.1	92	0.81	580.7		578	
315S-8	55	740	111	93.8	0.81	709.7		830	
315M-8	75	740	151	93	0.82	967.9		930	
315L1-8	90	740	178	93.8	0.82	1161.5		1030	
315L2-8	110	740	217	94	0.82	1419.5		1200	
355S-8	132	740	261	93.7	0.82	1703.5		1820	
355M-8	160	740	314.7	94.2	0.82	2064.8		1900	
355L1-8	(185)	740	363.5	94.3	0.82	2387.5		2100	
355L2-8	200	740	387.4	94.5	0.83	2581.0		2180	
400S-8	250	742	487	94	0.83	3217.7		2376	
400M-8	280	742	545	94	0.83	3603.8		2452	
400L-8	315	742	613	94	0.83	4054.2		2587	
同步转速 600 r/min Synchronous speed 600 r/min 50Hz									
315S-10	45	590	99.6	91.5	0.74	728.4		2.0	900
315M-10	55	590	121	92.0	0.74	890.2			1110
315L-10	75	590	162.1	92.5	0.75	1213.9			1190
355S-10	90	580	191	93	0.78	1456.7			1690
355M1-10	110	580	230	93.2	0.78	1780.5	1820		
355M2-10	132	580	275	93.5	0.78	2136.6	1910		
355L1-10	160	580	333	93.5	0.78	2589.8	2120		
355L2-10	(185)	580	385	93.5	0.78	2994.4	2250		
400S1-10	185	593	367	93.5	0.82	2979.3	1.9		2365
400S2-10	200	593	396	93.5	0.82	3220.9			2365
400M-10	220	593	436	93.5	0.82	3543		2365	
400L-10	250	592	495	93.5	0.82	4032.9		2491	

注：带（）为不推荐规格。 Note: The data with '（）' are not recommended specifications.

B3安装、机座带底脚端盖无凸缘 B3 Mounting, frame with feet end-shield without flange.

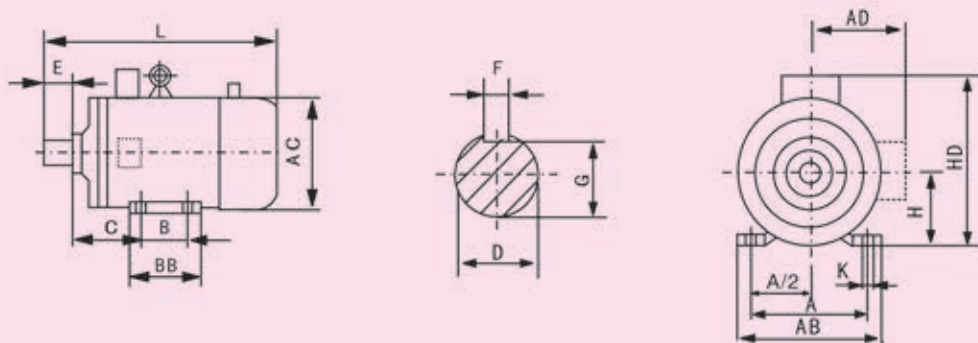

机座号 Frame size	极数 No. of poles	安装尺寸 Mounting dimensions in mm										外形尺寸 Overall dimension in mm															
		A	A/2	B	C	D	E	F	G	H	K	AB	AC	AD	BB	HD	L										
80M	2, 4	125	62.5	100	50	19	40	6	15.5	80	10	165	175	145	130	220	425										
90S	2, 4, 6	140	70	100	56	24	50	8	20	90		180	195	160				155	250	445							
90L				125							270				600												
100L		160	80	140	63	28	60		24	100		112	205	215		180	176	300	600								
112M		190	95	140	70						38				80					10	33	132	245	240	190	180	345
132S	2, 4, 6, 8	216	108	140	89	42	110	12	37	160		280	275	210		200	314	420	730								
132M				178							235				635												
160M		254	127	210	108	48	14	42.5	180	355		380	285	311		455	840										
160L				254							349				880												
180M		279	139.5	241	121	55	16	49	200	395		420	315	365		505	920										
180L				279							366				975												
200L		318	159	305	133	60	140	18	53	225		435	475	345		391	560	970									
225S		4, 8	356	178	286						149				55				110	16	49	225	435	475	345	391	560
225M		2			311	60	18	53	250	490		515	385	445		615	1070										
250M		4, 6, 8	406	203	349						168				65			140	20	67.5	280	550	580	410	520	680	1125
280S	2	457				228.5	368	190	75	140		18	58	280		550	580										
280M	4, 6, 8		419	75	18						58				280			550	580	410	560	680	1175				
315S	2																							406	170	22	71
315M	4, 6, 8, 10		508	254	457						216				65			140	18	58	315	630	645				
315L	2	508				80	170	22	71	630		645	576	315		630	645							576	716	845	1450
315L	4, 6, 8, 10		80	170	22						71				315			630	645	576	315	630	645				

B3安装、机座带底脚、端盖无凸缘 B3 Mounting, frame with feet end-shield without flange.

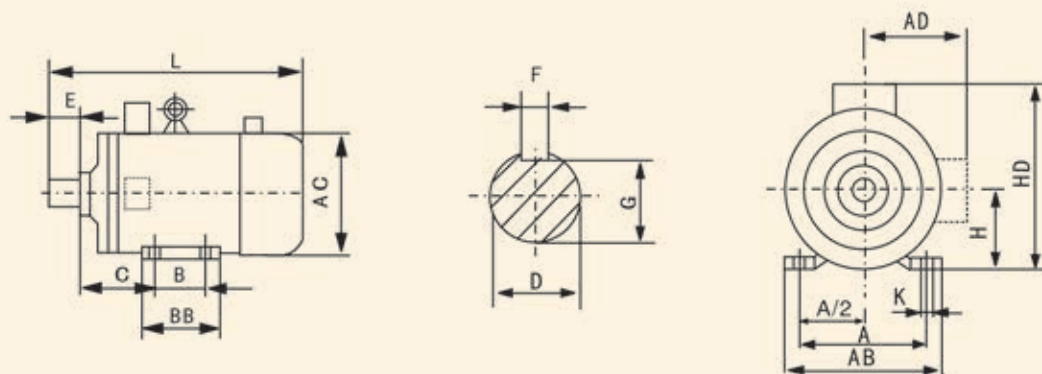

机座号 Frame size	极 数 No. of poles	安 装 尺 寸 Mounting dimensions in mm									外 形 尺 寸 Overall dimension in mm								
		A	A/2	B	C	D	E	F	G	H	K	AB	AC	AD	BB	HD	L		
355S	2	610	305	500	254	75	140	20	67.5	355	28	730	710	655	750	1010	1620		
	4,6,8,10	610	305	500	254	95	170	25	86	355									
355M	2	610	305	560	254	75	140	20	67.5	355								750	1680
	4,6,8,10	610	305	560	254	95	170	25	86	355									
355L	2	610	305	630	254	75	140	20	67.5	355					750		1800		
	4,6,8,10	610	305	630	254	95	170	25	86	355									
S 400M L	2	686	343	560	280	75	140	20	67.5	400	35	800	790	480		900		1130	
				630															
	4-16			100		210	28	90	1900										

B5安装、机座无底脚端盖有凸缘 B5 Mounting, frame without feet end-shield with flange.

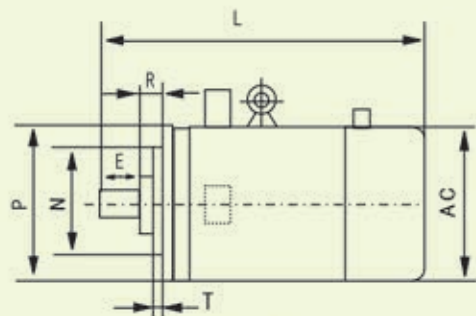

250-280

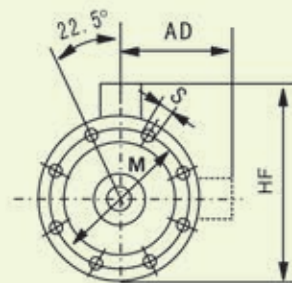
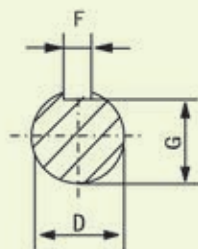

250-280

机座号 Frame Size	凸缘号 Flange NO.	极数 No. of poles	安装尺寸 Mounting dimension in mm											外形尺寸 Overall dimension in mm											
			D	E	F	G	M	N	P	R	S	T	凸缘孔数 No. of flange hole	AC	AD	HF	L								
250M	FF500	2	60	140	18	53	500	450	550	0	19	5.0	8	500	500	600	1085								
		4、6、8	65			58																			
280S		2	65		20	67.5												560	550	660	1135				
		4、6、8	75																						
280M		2	65		20	67.5																560	550	660	1185
		4、6、8	75																						

B35安装、机座带底脚、端盖有凸缘

B35 Mounting, frame with feet end-shield with flange.

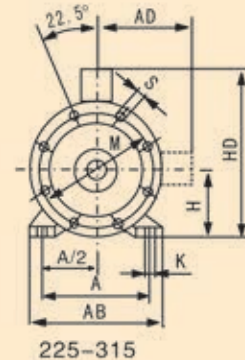
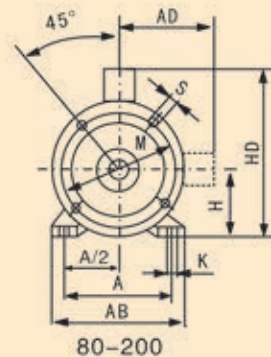
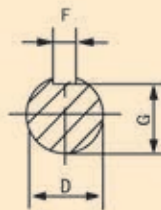
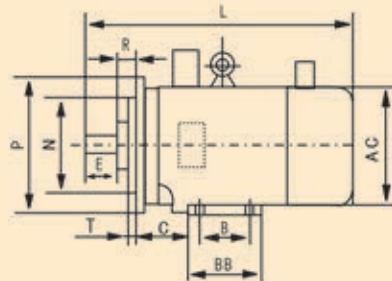

80-200

225-315

机座号 Frame Size	凸缘号 Flange No.	极数 No. of poles	安装尺寸 Mounting dimensions in mm																	外形尺寸 Overall dimensions in mm																							
			A	A/2	B	C	D	E	F	G	H	K	N	M	P	R	S	T	凸缘孔数 No. of flange hole	AB	AC	AD	BB	HD	L																		
80M	FF165	2, 4	125	62.5	100	50	19	40	6	15.5	80	10	130	165	200	12	3.5	4	165	175	150	130	175	425																			
90S		140	70	100	56	24	50	8	20	90	195														445																		
90L	FF215	2, 4, 6	160	80	140	63	28	60	10	33	132	12	180	215	250	15	4	4	205	215	180	176	245	600																			
112M					190	95																			140	70	24	100	112	245	240	190	180	265	600								
132S	FF265	2, 4, 6, 8	216	108	140	89	38	80	10	33	132	15	230	265	300	15	4	4	280	275	210	200	315	595																			
132M					178	89																			38	80	10	33	132	230	265	300	280	275	210	200	315	595					
160M	FF300	2, 4, 6, 8	254	127	210	108	42	110	12	37	160	15	250	300	350	19	5	4	330	335	265	270	385	730																			
160L					254																				108	42	110	12	37	160	15	250	300	350	19	5	4	330	335	265	270	385	730
180M					241																				121	48	110	14	42.5	180	15	250	300	350	19	5	4	335	380	285	311	430	840
180L					279																				139.5	279	121	48	110	14	42.5	180	15	250	300	350	19	5	4	335	380	285	311
200L	FF350	4, 8	318	159	305	133	55	110	16	49	200	19	300	350	400	19	5	4	395	420	315	365	475	920																			
225S	2	356	178	286	149	60	140		18	53	225														19	350	400	450	0	19	5	4	366	530	975								
225M	FF400	4, 6, 8	356	178	311	149	60	140	16	49	225	19	350	400	450	19	5	4	435	475	345	391	530	970																			
250M		2			406																				203	349	168	60	140	18	53	250	19	490	515	358	445	575	1070				
280S	FF500	2	457	228.5	368	190	65	140	18	58	280	24	450	500	550	19	5	4	550	580	410	520	640	1125																			
280M		4, 6, 8																							65	140	18	58	280	24	450	500	550	19	5	4	550	580	410	520	640	1125	
315S		2																							406	203	349	168	60	140	18	53	250	19	490	515	358	445	575	1070			
315M	FF600	4, 6, 8, 10	508	254	457	216	65	140	18	58	315	28	550	600	660	19	5	4	630	645	576	630	862	1480																			
315L		2																							406	203	349	168	60	140	18	53	250	19	490	515	358	445	575	1070			
315S		4, 6, 8, 10																							65	140	18	58	315	28	550	600	660	19	5	4	630	645	576	630	862	1480	
315M		2																							406	203	349	168	60	140	18	53	250	19	490	515	358	445	575	1070			
315L	4, 6, 8, 10	65	140	18	58	315	28	550	600	660	19	5	4	630	645	576	630	862	1480																								

V1安装、机座无底脚、端盖有凸缘、轴伸向下 V1 Mounting frame without feet, end-shield with flange shaft extensions downward.

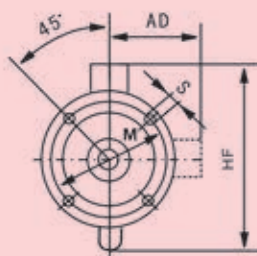
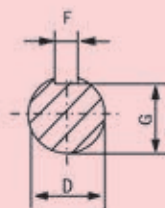
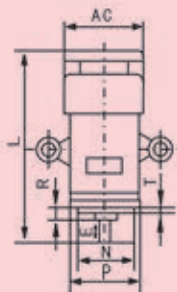

80-200

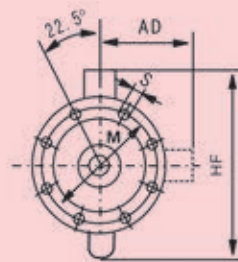

225-315

机座号 Frame Size	凸缘号 Flange No.	极数 No. of poles	安装尺寸 Mounting dimensions in mm										外形尺寸 Overall dimensions in mm					
			D	E	F	G	M	N	P	R	S	T	凸缘孔数 No. of flange hole	AC	AD	HF	L	
80M	FF165	2, 4	19	40	6	15.5	165	130	200	0	12	3.5	4	175	150	185	482	
90S		2, 4, 6	24	50	8	20								240	190	265	195	160
90L	28		60	24	215	180	250	215	180		245	660						
100L	FF215	2, 4, 6	38	80	10	33	265	230	300		15	4		4	240	190	265	660
112M															275	210	315	645
132S	FF265	2, 4, 6	42	110	12	37	300	250	350		19	5		4	4	355	265	385
132M													48			14	42.5	380
160M	FF300	2, 4, 6, 8	55	16	49	350	300	400	400		19	5	4	4	420	315	550	980
160L															60	18	53	475
180M	FF350	2, 4, 6, 8	60	18	49	400	350	450	450		19	5	4	4	515	385	650	1130
180L										65					58	580	410	720
200L	FF400	4, 8	75	20	67.5	500	450	550	550	19	5	4	4	580	410	720	1255	
225S														2	18	58	645	576
225M	FF500	4, 6, 8	80	20	67.5	600	550	660	660	24	6	4	4	645	576	900	1560	
250M														2	18	58	645	576
280S	FF500	4, 6, 8	75	18	58	600	550	660	660	24	6	4	4	645	576	900	1530	
280M														2	18	58	645	576
315S	FF600	4, 6, 8, 10	80	22	71	600	550	660	660	24	6	4	4	645	576	900	1560	
315M														2	18	58	645	576
315L	FF600	4, 6, 8, 10	80	22	71	600	550	660	660	24	6	4	4	645	576	900	1560	
315L														2	18	58	645	576

B35安装、机座带底脚、端盖有凸缘 B35 Mounting, frame with feet end-shield with flange.

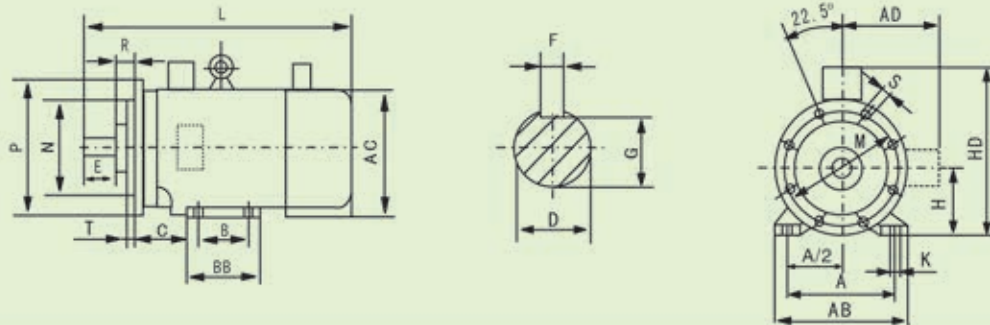





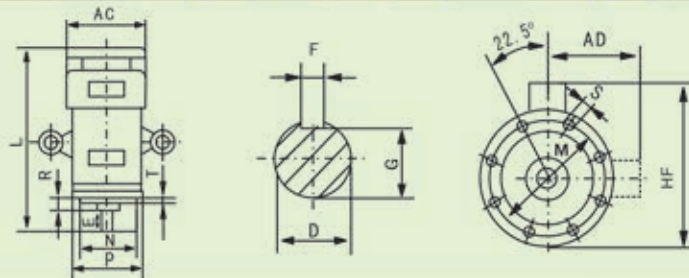



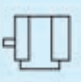
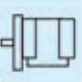
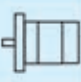

机座号 Frame Size	凸缘号 Flange No.	极数 No. of poles	安装尺寸 Mounting dimensions in mm																外形尺寸 Overall dimensions in mm						
			A	A/2	B	C	D	E	F	G	H	K	M	N	P	R	S	T	凸缘孔数 No. of flange hole	AB	AC	AD	BB	HD	L
355S	FF740	2	610	305	500	254	75	140	20	67.5	355	28	740	680	800	0	24	6.0	8	740	750	710	630	1080	1620
		4, 6, 8, 10			500	254	95	170	25	86															
2		560			254	75	140	20	67.5																
4, 6, 8, 10		560			254	95	170	25	86																
2		630			254	75	140	20	67.5																
4, 6, 8, 10		630			254	95	170	25	86																
355L	FF940	2	686	343	560	280	75	140	20	67.5	400	35	940	880	1000	0	28	6	8	800	790	480	900	1130	1880
4-16		630			100		210	28	90																
400M L	FF940	2	686	343	560	280	75	140	20	67.5	400	35	940	880	1000	0	28	6	8	800	790	480	900	1130	1880
L		4-16			710		100	210	28	90															

V1安装、机座无底脚、端盖有凸缘、轴伸向下
V1 Mourting frame without feet, end-shield with
flange shaft extensions downward.



机座号 Frame Size	凸缘号 Flange No.	极数 No. of poles	安装尺寸 Mounting dimensions in mm.											外形尺寸 Overall dimensions in mm			
			D	E	F	G	M	N	P	R	S	T	凸缘孔数 No. of flange hole	AC	AD	HF	L
355S	FF740	2	75	140	20	67.5	740	680	800	0	24	6.0	8	750	725	900	1720
		4, 6, 8, 10	95	170	25	86											
355M		2	75	140	20	67.5											
		4, 6, 8, 10	95	170	25	86											
355L		2	75	140	20	67.5											
		4, 6, 8, 10	95	170	25	86											
400	FF940	2	75	140	20	67.5	940	880	1000	0	28	6	8	790	710	1970	
		4-16	100	210	28	90											

安装型式 Mounting arrangement

机座号 Frame size	基本安装结构型式 Basic mounting arrangement			派生安装结构型式 Derived mounting arrangement								
	B3	B35	B5	采用 B5 型 B5 may be selected		采用 B3 型 B3 may be selected					采用 B35 型 B35 may be selected	
				V1	V3	V5	V6	B8	B6	B7	V15	V36
												
80~355	√	-	-	-	-	-	-	-	-	-	-	-
80~280	√	√	√	√	-	-	-	-	-	-	-	-
80~355	√	√	-	-	-	-	-	-	-	-	-	-
80~160	√	√	√	√	√	√	√	√	√	√	√	√
80~225	√	√	√	√	-	-	-	-	-	-	-	-
180~400	√	√	-	√	-	-	-	-	-	-	-	-



SINOPEC 市场成员证书



CNPC 认证证书



俄罗斯防爆产品认证证书



ISO9001:2000认证证书

为全球提供安全、可靠、节能、环保的驱动力



乘风破浪

中国 佳木斯防爆电机有限公司

JIAMUSI EXPLOSION-PROOF ELECTRIC MOTOR CO.,LTD

厂址：中国黑龙江省佳木斯市东风区建国街418号

电话：0454-8337277 0454-8337213 0454-8337090

传真：0454-8337750

邮编：154005