

中国·佳木斯防爆电机有限公司

JIAMUSI EXPLOSION-PROOF ELECTRIC MOTOR CO.,LTD



Y、YKS、YKK系列

10KV 高压

三相异步电动机



概述

Y、YKS、YKK系列高压10kV三相异步电动机是我公司采用国内外先进技术，结合我公司长期生产高压电动机的实践经验而设计制造的优化系列产品，是JS、JSQ老系列高压电机的更新换代产品，与JS、JSQ老系列产品相比，具有结构紧凑、重量轻、高效、节能、噪声低、振动小、可靠性高、使用寿命长、安装维护方便等优点。

本系列电动机适用于驱动各种通风机、压缩机、水泵、破碎机、切屑机床、运输机械等通用机械及其它机械设备，在矿山、机械、石油、化工、电站等各种工矿企业中作原动机用，如用以传动鼓风机、磨煤机、轧钢机、卷扬机、皮带机的电动机在订货时需提供有关技术资料，并要签订技术协议，作为电机特殊设计的依据，以确保电机的可靠运行。

本系列电动机采用F级绝缘，温升按B级考核，额定频率50Hz，额定电压10kV，也可按订货要求制造成其它要求的电动机。

本系列电动机的基本安装型式为卧式带底脚（IMB3）结构。

Y系列为基本系列电动机，YKS、YKK系列是根据电动机的冷却方式和防护等级不同而派生的系列产品，Y、YKS、YKK系列产品特征见表1。

本系列电动机符合国际电工委员会IEC有关标准，符合GB755《旋转电机定额和性能》的规定。

General

Y, YKS and YKK ranges of high - 10kV voltage three - phase induction motors are optimum series products which are designed and manufactured by our company using advanced technique at home and abroad, in combination practical experiment of our company on production of high-voltage motors, and are renewing and generation - changing products of former JS and JSQ series high - voltage motors. They have advantages of compact construction, light weight, high efficiency, energy-saving, low noise, small vibration, high reliability, long service life, easy mounting and maintenance, etc., as compared with former JS and JSQ series products.

This range of motors are suitable for driving the general-purpose machineries such as all kinds of ventilators, compressors, water pumps, crushers, cutting machine tools and transportation machineries, etc. as well as other machineries, and act as a motive power machine in all kinds of industrial and mining establishments such as mining, machinery, petroleum, and chemical industries as well as the power plant, etc. If the motors are used to drive the blower, the coal-grinder, the rolling mill, the lifting winch and the belt conveyer, the relevant technical information should be supplied when ordering, and the technical agreement should be signed, which is taken as a basis of special design of motors, thus ensuring the motor to operate reliably.

The motors are class F insulated, but thermally utilized according to class B. Rated frequency is 50Hz, rated voltage is 10 kV, and the motors of 60Hz and other voltages can also be available on request of ordering.

The basic mounting arrangement of motors of this range is of the horizontally foot-mounted construction (IMB3).

Y is a basic range of motors. YKS and YKK ranges are series products derived according to different methods of cooling and degrees of protection.

The features of YKS and YKK ranges of products are shown in the table 1.

This range of motors conform to the relevant IEC standards and GB755 Rotating Electrical Machines-Ratings and Performances.

表 1 Table 1

系 列 Range	型 号 Enclosure	冷却方式 Method of cooling	防护等级 Degree of protection	冷却结构 Cooling construction
Y	开启式 Opened	IC01	IP23	带通风顶罩和不带顶罩在机座侧板开窗口两种形式 With the ventilating top cover and without the ventilating top cover but making a window in the side plate of frame
	管道通风式 Pipe-ventilated	IC11、IC21、 IC31	IP44	管道通风 Pipe-ventilated
YKS	空 / 水冷却 封闭式 Air-to-water cooled, enclosed	IC81W	IP44 或 IP54	机座顶部带空/水冷却器 Air-to water cooler located at the top of frame
YKK	空 / 空冷却 封闭式 Air-to-air cooled, enclosed	IC611或IC616	IP44 或 IP54	机座顶部带空/空冷却器 Air-to-air cooler located at the top of frame



结构特点

电动机采用箱型结构，机座由钢板焊接成箱形，重量轻、刚度好。机座两侧面及顶部开有窗口，便于电动机的维护保养，并且在顶部安装不同的冷却器，可以派生不同冷却方式和不同防护等级的电动机。

定子采用外装压结构，定子绕组采用F级绝缘材料，采有可靠的防电晕措施，绕组端部有可靠的固定及绑扎，并采用真空压力浸渍无溶剂漆工艺（VPI）处理，因此电动机的绝缘性能好，机械强度高、防潮能力强、使用寿命长。

鼠笼转子有铸铝和铜条两种结构，采用先进可靠的铸铝工艺或焊接工艺制造而成，并经过动平衡校验，电动机运行平稳可靠。

轴承采用滚动轴承和滑动轴承两种形式，由电动机功率大小和转速高低而定，其防护等级为IP44或IP54，滚动轴承设有不停机注排油装置。

主接线盒置于电动机右侧（从轴伸端看），也可接用户要求置于左侧，接线盒内外均设有单独的接地端子。

根据用户要求，可在定子绕组，轴承等重要部位加设测温装置，便于现场观察和远距离监控，以保证电动机安全可靠地运行。

Features of construction

The motors are of box-section construction, the frame is welded into box-section using steel pated, and hence the weight of motors is light and rigidity is good. Two sides and top of the frame are all provided with the windows, which, on the one hand, is convenient to maintain and take care of motors, and on the other hand, can mount different coolers on the top of frame, thus being capable of deriving the motors with different methods of cooling and different degrees of protection.

The motor has a laminated core which is first compressed and secured before it is fitted into the frame and then pressed into the machined frame, the motors have good insulating performance, higher mechanical strength, higher moisture-resistance and longer service life.

The squirrel-cage rotors are of both cast aluminum construction and copper bar construction. The rotors are manufactured using advanced & reliable cast-aluminum and welding process, and are well balanced. Therefore, the motors operate smoothly and reliably.

Rolling bearings or sleeve bearings are used for the motors, depending on the power and speed of motors. Degree of protection is IP44 or IP54. The rolling bearings are provided with grease-filling and-diaining devices without shutdown.

The main terminal box is located at the right side of the motor (viewed from the shaft extension), and can also be located at the left side on user request. Interior and exterior of the terminal box all are provided with separate earthing terminals.

On user request, the stator winding and the bearing can be provided with temperature-measuring devices so as to be convenient to observe them in site and monitor them in remote distance, thus ensuring the motor to operate safely and reliably.

电动机型号说明 Meaning of the type of motors

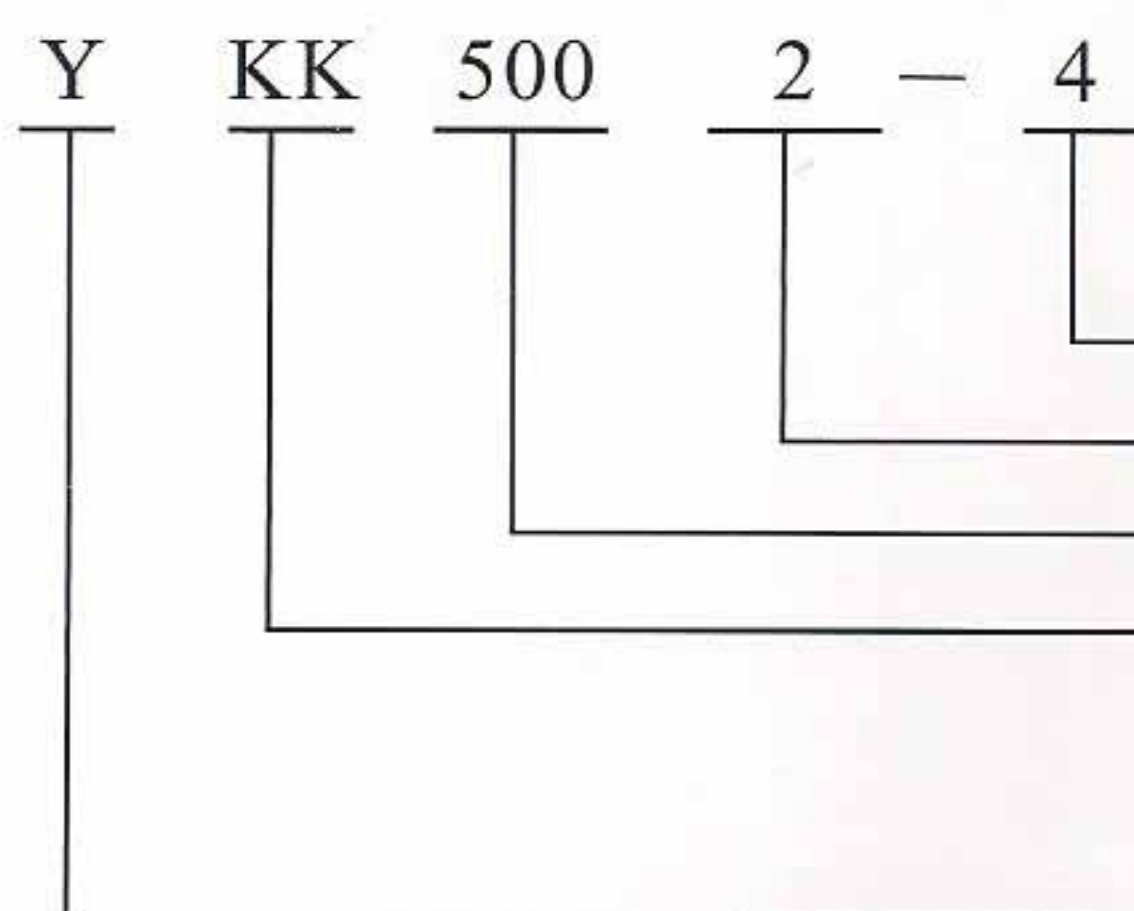

极数（4极）

No. of poles(4-pole)

铁心长代号（2）号

Core length(no.2)

电动机轴中心高（H500mm）

Shaft height(H500 mm)

冷却结构（KK为空/空冷却，KS为空/水冷却）

Cooling construction (KK represents air-to-air cooling; KS represents air-to-water cooling)

“异”步电动机

Induction motor

技术数据（保证值）

Y、YKS系列高压三相异步电动机 见表2

YKK系列高压三相异步电动机 见表3

Technical data (Guarantee value)

Technical data of Y and YKS ranges of high-voltage three-phase induction motors are shown in table 2.

Technical data of YKS ranges of increased-safety high-voltage three-phase induction motors are shown in table 3.



表2 Y、YKS系列高压三相异步电动机技术数据

Table 2 Technical data of Y and YKS ranges of high-voltage three-phase induction motors

机座号 Frame size	额定功率 Rated output (kW)	定子电流 Stator current (A)	额定转速 Rated speed (r/min)	效率 Eff. (%)	功率因数 Power factor (cos φ)	最大转矩	堵转转矩	堵转电流	转动惯量		重量 Weight (kg)	
						额定转矩 Breakdown torque Rated torque	额定转矩 Locked-rotor torque Rated torque	额定电流 Locked-rotor current Rated current	电机 Motor Jm (kg.m ²)	允许负载 Permissible load J (kg.m ²)	Y	YKS
4501-2	220	15.9	2973	92.7	0.86	1.8	0.6	7.0	4.0	30.0	2935	3535
4502-2	250	18.0	2974	93.0	0.86	1.8	0.6	7.0	4.5	31.1	2950	3550
4503-2	280	20.1	2975	93.4	0.86	1.8	0.6	7.0	5.3	31.8	3000	3600
4504-2	315	22.4	2976	93.6	0.87	1.8	0.6	7.0	6.0	32.5	3098	3690
4505-2	355	25.2	2977	93.8	0.87	1.8	0.6	7.0	6.4	34.3	3160	3760
4506-2	400	28.3	2977	94.1	0.87	1.8	0.6	7.0	7.5	35.1	3250	3850
4507-2	450	31.7	2979	94.4	0.87	1.8	0.6	7.0	8.4	37.2	3290	3890
4508-2	500	35.2	2979	94.3	0.87	1.8	0.6	7.0	9.0	41.2	3370	3970
4509-2	560	39.4	2980	94.5	0.87	1.8	0.6	7.0	9.7	45.2	3600	4200
4510-2	630	44.2	2980	94.6	0.87	1.8	0.6	7.0	10.3	50.1	3760	4360
5001-2	710	49.2	2981	94.7	0.88	1.8	0.6	7.0	13.7	68.8	4150	4810
5002-2	800	55.4	2981	94.8	0.88	1.8	0.6	7.0	14.7	75.5	4250	4910
5003-2	900	62.2	2981	94.9	0.88	1.8	0.6	7.0	16.7	78.4	4500	5160
5004-2	1000	69.1	2982	95.0	0.88	1.8	0.6	7.0	17.7	90.0	4600	5260
5005-2	1120	77.2	2982	95.2	0.88	1.8	0.6	7.0	18.7	97.0	4700	6350
5601-2	1250	85.0	2983	95.4	0.89	1.8	0.6	7.0	30.8	98.0	7750	8450
5602-2	1400	95.1	2983	95.5	0.89	1.8	0.6	7.0	34.7	99.0	8000	8700
5603-2	1600	108.6	2983	95.6	0.89	1.8	0.6	7.0	38.8	100	8250	8950
6301-2	1800	120.7	2983	95.7	0.90	1.8	0.6	7.0	39.0	108	9250	10010
6302-2	2000	134.0	2983	95.8	0.90	1.8	0.6	7.0	44.0	110	9650	10410
6303-2	2240	149.7	2984	96.0	0.90	1.8	0.6	7.0	51.0	114	10500	11260
4501-4	220	16.3	1477	92.5	0.84	1.8	0.7	7.0	9.0	78.0	2550	3365
4502-4	250	18.5	1477	92.7	0.84	1.8	0.7	7.0	9.5	87.0	2645	3460
4503-4	280	20.5	1478	92.9	0.85	1.8	0.7	7.0	10.2	97.0	2710	3525
4504-4	315	23.0	1478	93.1	0.85	1.8	0.7	7.0	10.8	107	2790	3650
4505-4	355	25.5	1478	93.3	0.86	1.8	0.7	7.0	12.0	119	2850	3665



续表2 Y、YKS系列高压三相异步电动机技术数据

Table 2 Technical data of Y and YKS ranges of high-voltage three-phase induction motors

机座号 Frame size	额定功率 Rated output (kW)	定子电流 Stator current (A)	额定转速 Rated speed (r/min)	效率 Eff. (%)	功率因数 Power factor (cos φ)	最大转矩	堵转转矩	堵转电流	转动惯量		重量 Weight (kg)	
						额定转矩 Breakdown torque Rated torque	额定转矩 Locked-rotor torque Rated torque	额定电流 Locked-rotor current Rated current	电机 Motor J _m (kg.m ²)	允许负载 Permissible load J (kg.m ²)	Y	YKS
4506-4	400	28.7	1480	93.5	0.86	1.8	0.7	7.0	12.5	132	2915	3730
4507-4	450	32.2	1482	93.9	0.86	1.8	0.7	7.0	12.9	147	3180	3995
4508-4	500	35.7	1485	94.0	0.86	1.8	0.7	7.0	13.4	161	3315	4130
4509-4	560	39.9	1485	94.2	0.86	1.8	0.7	7.0	13.8	178	3380	4195
4510-4	630	44.8	1485	94.4	0.86	1.8	0.7	7.0	14.7	196	3461	4275
5001-4	710	49.6	1485	95.0	0.87	1.8	0.7	7.0	22.0	217	4550	5510
5002-4	800	55.8	1486	95.1	0.87	1.8	0.7	7.0	23.0	240	4600	5560
5003-4	900	62.0	1487	95.2	0.88	1.8	0.7	7.0	25.0	265	4750	5710
5004-4	1000	68.8	1487	95.3	0.88	1.8	0.7	7.0	27.0	289	4850	5810
5005-4	1120	77.0	1487	95.4	0.88	1.8	0.7	7.0	29.0	317	5150	6110
5601-4	1250	84.9	1485	95.5	0.89	1.8	0.7	7.0	40.0	347	6225	7245
5602-4	1400	94.9	1485	95.7	0.89	1.8	0.7	7.0	43.0	379	6720	7740
5603-4	1600	108.3	1487	95.8	0.89	1.8	0.7	7.0	46.0	421	7150	8170
6301-4	1800	121.8	1488	95.9	0.89	1.8	0.6	7.0	86.0	460	9250	10360
6302-4	2000	135.1	1488	96.0	0.89	1.8	0.6	7.0	91.0	498	9700	10810
6303-4	2240	151.2	1488	96.1	0.89	1.8	0.6	7.0	96.0	540	10600	11710
4504-6	220	17.0	987	92.2	0.81	1.8	0.7	6.0	13.2	210	2800	3615
4505-6	250	19.3	987	92.4	0.81	1.8	0.7	6.0	13.4	236	2850	3665
4506-6	280	21.3	987	92.6	0.82	1.8	0.7	6.0	13.6	261	2950	3765
4507-6	315	23.9	988	92.8	0.82	1.8	0.7	6.0	14.7	291	3070	3885
4508-6	355	26.5	988	93.1	0.83	1.8	0.7	6.0	15.7	324	3175	3990
4509-6	400	30.0	988	93.3	0.83	1.8	0.7	6.0	17.7	361	3295	4110
4510-6	450	33.5	988	93.5	0.83	1.8	0.7	6.0	18.2	400	3377	4190
5001-6	500	37.0	988	93.9	0.83	1.8	0.7	6.0	23.0	440	4550	5510
5002-6	560	40.9	988	94.1	0.84	1.8	0.7	6.0	25.0	486	4600	5560
5003-6	630	45.9	989	94.4	0.84	1.8	0.7	6.0	27.0	539	4790	5750



续表2 Y、YKS系列高压三相异步电动机技术数据

Table 2 Technical data of Y and YKS ranges of high-voltage three-phase induction motors

机座号 Frame size	额定功率 Rated output (kW)	定子电流 Stator current (A)	额定转速 Rated speed (r/min)	效率 Eff. (%)	功率因数 Power factor (cos φ)	最大转矩	堵转转矩	堵转电流	转动惯量		重量 Weight (kg)	
						额定转矩	额定转矩	额定电流	电机 Motor J _m (kg.m ²)	允许负载 Permissible load J (kg.m ²)	Y	YKS
						Breakdown torque	Locked-rotor torque	Locked-rotor current				
						Rated torque	Rated torque	Rated current				
5004-6	710	51.6	990	94.6	0.84	1.8	0.7	6.0	29.0	599	4930	5890
5005-6	800	58.1	990	94.7	0.84	1.8	0.7	6.0	31.0	664	5050	6010
5601-6	900	64.4	988	94.9	0.85	1.8	0.7	6.0	49.0	735	6085	7195
5602-6	1000	71.4	988	95.1	0.85	1.8	0.7	6.0	53.0	805	6415	7525
5603-6	1120	79.8	989	95.3	0.85	1.8	0.7	6.0	56.0	886	6670	7780
5604-6	1250	88.0	989	95.4	0.86	1.8	0.7	6.0	60	972	6920	8030
6301-6	1400	98.2	989	95.7	0.86	1.8	0.6	6.0	114	1068	9300	10410
6302-6	1600	112.1	990	95.8	0.86	1.8	0.6	6.0	121	1192	9700	10810
6303-6	1800	126.0	991	95.9	0.86	1.8	0.6	6.0	128	1312	10500	11610
4508-8	220	17.9	741	92.2	0.77	1.8	0.7	6.0	16.0	423	2927	3740
4509-8	250	20.3	741	92.4	0.77	1.8	0.7	6.0	17.0	476	3241	4056
4510-8	280	22.7	741	92.6	0.77	1.8	0.7	6.0	18.0	528	3383	4198
5001-8	315	25.5	741	92.8	0.77	1.8	0.7	6.0	22.0	588	4450	5410
5002-8	355	28.6	742	93.1	0.77	1.8	0.7	6.0	24.0	656	4580	5540
5003-8	400	31.7	742	93.2	0.78	1.8	0.7	6.0	26.0	730	4700	5660
5004-8	450	35.7	742	93.4	0.78	1.8	0.7	6.0	28.0	812	4850	5810
5005-8	500	39.0	742	93.8	0.79	1.8	0.7	6.0	30.0	893	5960	6920
5006-8	560	43.6	742	93.9	0.79	1.8	0.7	6.0	32.0	989	6100	7060
5601-8	630	47.0	743	94.4	0.82	1.8	0.7	6.0	56.0	1098	6325	7345
5602-8	710	52.8	743	94.6	0.82	1.8	0.7	6.0	60.0	1221	6470	7490
5603-8	800	59.5	744	94.7	0.82	1.8	0.7	6.0	63.0	1357	6620	7640
5604-8	900	66.8	744	94.8	0.82	1.8	0.7	6.0	67.0	1505	6760	7780
6301-8	1000	73.2	744	95.0	0.83	1.8	0.7	6.0	141	1650	9620	10760
6302-8	1120	81.8	744	95.2	0.83	1.8	0.7	6.0	149	1820	10200	11310
6303-8	1250	91.2	744	95.3	0.83	1.8	0.7	6.0	157	2001	10570	11680
5001-10	220	18.7	592	91.9	0.74	1.8	0.7	5.5	27.0	740	4500	5460



续表2 Y、YKS系列高压三相异步电动机技术数据

Table 2 Technical data of Y and YKS ranges of high-voltage three-phase induction motors

机座号 Frame size	额定功率 Rated output (kW)	定子电流 Stator current (A)	额定转速 Rated speed (r/min)	效率 Eff. (%)	功率因数 Power factor (cos φ)	最大转矩	堵转转矩	堵转电流	转动惯量		重量 Weight (kg)	
						额定转矩 Breakdown torque Rated torque	额定转矩 Locked-rotor torque Rated torque	额定电流 Locked-rotor current Rated current	电机 Motor Jm (kg.m ²)	允许负载 Permissible load J (kg.m ²)	Y	YKS
5002-10	250	21.2	592	92.2	0.74	1.8	0.7	5.5	27.5	820	4600	5560
5003-10	280	23.7	592	92.4	0.74	1.8	0.7	5.5	28.0	910	4720	5680
5004-10	315	26.6	592	92.6	0.74	1.8	0.7	5.5	30.0	1014	4840	5800
5005-10	355	29.5	592	92.8	0.75	1.8	0.7	5.5	31.3	1131	4970	5930
5006-10	400	33.2	593	93.0	0.75	1.8	0.7	5.5	32.0	1261	5090	6050
5601-10	450	36.2	593	93.2	0.77	1.8	0.7	6.0	75.0	1403	6160	7180
5602-10	500	40.1	594	93.4	0.77	1.8	0.7	6.0	80.0	1544	6360	7380
5603-10	560	44.3	594	93.5	0.78	1.8	0.7	6.0	84.0	1710	6570	7590
5604-10	630	49.8	595	93.7	0.78	1.8	0.7	6.0	89.0	1902	6780	7800
5605-10	710	53.7	595	93.9	0.78	1.8	0.7	6.0	94.0	2117	6990	8010
6301-10	800	61.2	595	94.3	0.80	1.8	0.7	6.0	144	2355	9620	10730
6302-10	900	68.7	595	94.5	0.80	1.8	0.7	6.0	153	2614	10200	11310
6303-10	1000	76.3	596	94.6	0.80	1.8	0.7	6.0	161	2870	10570	11680
6304-10	1120	85.9	596	94.7	0.80	1.8	0.7	6.0	169	3170	10930	12040
5004-12	220	19.1	493	91.2	0.73	1.8	0.7	5.5	43.0	1135	4770	5730
5005-12	250	21.6	493	91.6	0.73	1.8	0.7	5.5	47.0	1210	4880	5840
5006-12	280	24.1	494	92.0	0.73	1.8	0.7	5.5	50.0	1418	5030	5990
5601-12	315	27.0	494	92.3	0.73	1.8	0.7	6.0	73.0	1580	6060	7080
5602-12	355	30.4	495	92.5	0.73	1.8	0.7	6.0	77.0	1763	6255	7275
5603-12	400	34.1	495	92.7	0.73	1.8	0.7	6.0	82.0	1967	6450	7470
5604-12	450	38.3	495	92.9	0.73	1.8	0.7	6.0	87.0	2190	6640	7660
5605-12	500	42.4	495	93.2	0.73	1.8	0.7	6.0	92.0	2411	6830	7850
6301-12	560	46.7	495	93.5	0.74	1.8	0.7	6.0	119	2672	9600	10710
6302-12	630	52.5	495	93.7	0.74	1.8	0.7	6.0	136	2974	10050	11160
6303-12	710	59.0	495	93.9	0.74	1.8	0.7	6.0	152	3313	10450	11560
6304-12	800	66.2	495	94.3	0.74	1.8	0.7	6.0	160	3688	10820	11930



表3 YKK系列高压三相异步电动机技术数据

Table 3 Technical data of YKK ranges of high-voltage three-phase induction motors

机座号 Frame size	额定功率 Rated output (kW)	定子电流 Stator current (A)	额定转速 Rated speed (r/min)	效率 Eff. (%)	功率因数 Power factor (cos φ)	最大转矩	堵转转矩	堵转电流	转动惯量		重量 Weight (kg)
						额定转矩 Breakdown torque Rated torque	额定转矩 Locked-rotor torque Rated torque	额定电流 Locked-rotor current Rated current	电机 Motor J _m (kg.m ²)	允许负载 Permissible load J (kg.m ²)	
YKK4501-2	220	16.2	2972	92.4	0.85	1.8	0.6	7.0	5.1	30.0	3650
YKK4502-2	250	18.3	2972	92.6	0.85	1.8	0.6	7.0	5.6	31.1	3740
YKK4503-2	280	20.5	2973	92.8	0.85	1.8	0.6	7.0	6.1	31.8	3800
YKK4504-2	315	23.0	2973	93.0	0.85	1.8	0.6	7.0	6.6	32.5	3880
YKK4505-2	355	25.5	2975	93.3	0.86	1.8	0.6	7.0	7.2	34.3	3945
YKK4506-2	400	28.7	2975	93.7	0.86	1.8	0.6	7.0	8.2	35.2	4090
YKK4507-2	450	32.1	2976	94.0	0.86	1.8	0.6	7.0	8.7	37.2	4185
YKK5001-2	500	35.6	2975	94.2	0.86	1.8	0.6	7.0	14.7	55.4	4290
YKK5002-2	560	39.8	2975	94.4	0.86	1.8	0.6	7.0	15.7	59.1	4380
YKK5003-2	630	44.2	2976	94.6	0.87	1.8	0.6	7.0	17.7	63.2	4575
YKK5004-2	710	49.8	2978	94.7	0.87	1.8	0.6	7.0	18.7	68.8	4700
YKK5005-2	800	56.0	2978	94.8	0.87	1.8	0.6	7.0	19.7	75.5	4780
YKK5601-2	900	63.0	2978	94.9	0.87	1.8	0.6	7.0	31.8	78.4	7750
YKK5602-2	1000	69.9	2979	95.0	0.87	1.8	0.6	7.0	35.7	90.0	8000
YKK5603-2	1120	78.1	2980	95.2	0.87	1.8	0.6	7.0	39.8	97.0	8250
YKK6301-2	1250	87.0	2980	95.3	0.87	1.8	0.6	7.0	42.7	98.0	9300
YKK6302-2	1400	97.4	2980	95.4	0.87	1.8	0.6	7.0	46.0	99.0	9700
YKK6303-2	1600	110.0	2981	95.5	0.88	1.8	0.6	7.0	53.0	100	10100
YKK4501-4	220	16.6	1483	92.4	0.83	1.8	0.7	7.0	11.4	78.0	3700
YKK4502-4	250	18.8	1483	92.6	0.83	1.8	0.7	7.0	12.6	87.0	3760
YKK4503-4	280	21.0	1482	92.8	0.83	1.8	0.7	7.0	13.1	97.0	3860
YKK4504-4	315	23.6	1482	93.0	0.83	1.8	0.7	7.0	13.5	107	3890
YKK4505-4	355	25.5	1483	93.3	0.86	1.8	0.7	7.0	14.0	119	4200
YKK4506-4	400	28.7	1483	93.5	0.86	1.8	0.7	7.0	14.4	132	4300
YKK4507-4	450	32.2	1485	93.9	0.86	1.8	0.7	7.0	15.3	147	4490
YKK5001-4	500	35.7	1484	94.0	0.86	1.8	0.7	7.0	25.0	165	5640
YKK5002-4	560	40.0	1484	94.2	0.86	1.8	0.7	7.0	26.0	182	5660
YKK5003-4	630	44.8	1485	94.4	0.86	1.8	0.7	7.0	28.0	201	5850
YKK5004-4	710	50.4	1485	94.6	0.86	1.8	0.7	7.0	30.0	220	6030



续表3 YKK系列高压三相异步电动机技术数据

Table 3 Technical data of YKK ranges of high-voltage three-phase induction motors

机座号 Frame size	额定 功率 Rated output (kW)	定子 电流 Stator current (A)	额定 转速 Rated speed (r/min)	效率 Eff. (%)	功率 因数 Power factor (cos φ)	最大转矩	堵转转矩	堵转电流	转动惯量		重量 Weight (kg)
						额定转矩 Breakdown torque Rated torque	额定转矩 Locked- rotor torque Rated torque	额定电流 Locked-rotor current Rated current	电机 Motor Jm (kg.m ²)	允许负载 Permis- sible load J (kg.m ²)	
YKK5005-4	800	56.0	1485	94.8	0.87	1.8	0.7	7.0	32.0	242	6060
YKK5601-4	900	63.0	1485	94.9	0.87	1.8	0.7	7.0	44.0	270	7800
YKK5602-4	1000	70.0	1485	95.0	0.87	1.8	0.7	7.0	47.0	292	8050
YKK5603-4	1120	78.2	1484	95.1	0.87	1.8	0.7	7.0	50.0	320	8300
YKK6301-4	1250	86.1	1485	95.2	0.88	1.8	0.6	7.0	90.0	350	9900
YKK6302-4	1400	96.4	1486	95.3	0.88	1.8	0.6	7.0	95.0	382	10300
YKK6303-4	1600	110	1486	95.4	0.88	1.8	0.6	7.0	101.0	423	10400
YKK4504-6	220	17.3	988	92.0	0.80	1.8	0.7	7.0	15.5	210	4090
YKK4505-6	250	19.6	988	92.2	0.80	1.8	0.7	7.0	16.3	235	4210
YKK4506-6	280	21.9	988	92.5	0.80	1.8	0.7	6.0	17.4	260	4420
YKK4507-6	315	23.9	987	92.8	0.82	1.8	0.7	6.0	18.4	290	4560
YKK5001-6	355	26.6	988	93.1	0.83	1.8	0.7	6.0	27.0	326	5360
YKK5002-6	400	29.8	988	93.3	0.83	1.8	0.7	6.0	29.0	362	5440
YKK5003-6	450	33.5	988	93.5	0.83	1.8	0.7	6.0	31.0	400	5700
YKK5004-6	500	37.1	989	93.9	0.83	1.8	0.7	6.0	33.0	446	5880
YKK5005-6	560	40.9	990	94.1	0.84	1.8	0.7	6.0	35.0	485	6110
YKK5601-6	630	45.9	990	94.4	0.84	1.8	0.7	6.0	50.0	540	7500
YKK5602-6	710	51.6	990	94.6	0.84	1.8	0.7	6.0	60.0	599	7850
YKK5603-6	800	58.1	991	94.7	0.84	1.8	0.7	6.0	63.0	665	8100
YKK5604-6	900	64.4	991	94.9	0.85	1.8	0.7	6.0	67.0	736	8300
YKK6301-6	1000	71.4	991	95.1	0.85	1.8	0.6	6.0	121	805	10750
YKK6302-6	1120	79.9	991	95.2	0.85	1.8	0.6	6.0	128	886	11150
YKK6303-6	1250	88.1	991	95.3	0.86	1.8	0.6	6.0	135	970	11500
YKK5001-8	220	18.2	740	92.0	0.76	1.8	0.7	6.0	28.0	423	5280
YKK5002-8	250	20.6	740	92.2	0.76	1.8	0.7	6.0	30.0	476	5430
YKK5003-8	280	23.0	740	92.5	0.76	1.8	0.7	6.0	32.0	530	5660
YKK5004-8	315	25.5	741	92.8	0.77	1.8	0.7	6.0	34.0	588	5700
YKK5005-8	355	28.6	741	93.1	0.77	1.8	0.7	6.0	36.0	656	5760
YKK5006-8	400	31.8	741	93.2	0.78	1.8	0.7	6.0	38.0	730	5820



续表3 YKK系列高压三相异步电动机技术数据

Table 3 Technical data of YKK ranges of high-voltage three-phase induction motors

机座号 Frame size	额定功率 Rated output (kW)	定子电流 Stator current (A)	额定转速 Rated speed (r/min)	效率 Eff. (%)	功率因数 Power factor (cos φ)	最大转矩	堵转转矩	堵转电流	转动惯量		重量 Weight (kg)
						额定转矩 Breakdown torque Rated torque	额定转矩 Locked-rotor torque Rated torque	额定电流 Locked-rotor current Rated current	电机 Motor J _m (kg.m ²)	允许负载 Permissible load J (kg.m ²)	
YKK5601-8	450	35.7	742	93.4	0.78	1.8	0.7	6.0	63.0	810	7850
YKK5602-8	500	39.0	742	93.8	0.79	1.8	0.7	6.0	67.0	890	8100
YKK5603-8	560	43.6	742	93.9	0.79	1.8	0.7	6.0	70.0	988	8300
YKK5604-8	630	47.0	743	94.4	0.82	1.8	0.7	6.0	74.0	1098	8500
YKK6301-8	710	52.8	743	94.6	0.82	1.8	0.7	6.0	145	1221	10400
YKK6302-8	800	59.5	743	94.7	0.82	1.8	0.7	6.0	151	1357	10800
YKK6303-8	900	66.8	743	94.8	0.82	1.8	0.7	6.0	166	1505	11200
YKK5003-10	220	19.2	593	91.9	0.72	1.8	0.7	5.5	38.0	698	5760
YKK5004-10	250	21.8	593	92.1	0.72	1.8	0.7	5.5	39.3	775	5930
YKK5005-10	280	23.7	594	92.4	0.74	1.8	0.7	5.5	40.0	865	6120
YKK5601-10	315	26.5	594	92.6	0.74	1.8	0.7	6.0	78.0	1014	7350
YKK5602-10	355	29.4	593	92.8	0.75	1.8	0.7	6.0	83.0	1131	7500
YKK5603-10	400	33.1	594	93.0	0.75	1.8	0.7	6.0	87.0	1261	7850
YKK5604-10	450	36.7	594	93.2	0.76	1.8	0.7	6.0	92.0	1403	8100
YKK5605-10	500	40.1	593	93.4	0.77	1.8	0.7	6.0	97.0	1544	8300
YKK6301-10	560	44.3	593	93.5	0.78	1.8	0.7	6.0	153	1710	10600
YKK6302-10	630	49.8	594	93.7	0.78	1.8	0.7	6.0	162	1902	11000
YKK6303-10	710	56.0	594	93.9	0.78	1.8	0.7	6.0	169	2116	11400
YKK6304-10	800	61.2	594	94.3	0.80	1.8	0.7	6.0	178	2355	11800
YKK5601-12	220	19.2	495	91.8	0.72	1.8	0.7	6.0	88.0	1135	7350
YKK5602-12	250	21.8	495	92.0	0.72	1.8	0.7	6.0	97.0	1210	7500
YKK5603-12	280	24.4	495	92.1	0.72	1.8	0.7	6.0	100	1418	7850
YKK5604-12	315	27.4	495	92.3	0.72	1.8	0.7	6.0	108	1580	8100
YKK5605-12	355	30.4	495	92.5	0.73	1.8	0.7	6.0	115	1763	8300
YKK6301-12	400	34.1	495	92.7	0.73	1.8	0.7	6.0	139	1967	10600
YKK6302-12	450	38.3	495	92.9	0.73	1.8	0.7	6.0	156	2190	11000
YKK6303-12	500	42.4	495	93.2	0.73	1.8	0.7	6.0	172	2411	11400
YKK6304-12	560	46.7	495	93.5	0.74	1.8	0.7	6.0	180	2672	11800



外形及安装尺寸

Overall and mounting dimensions

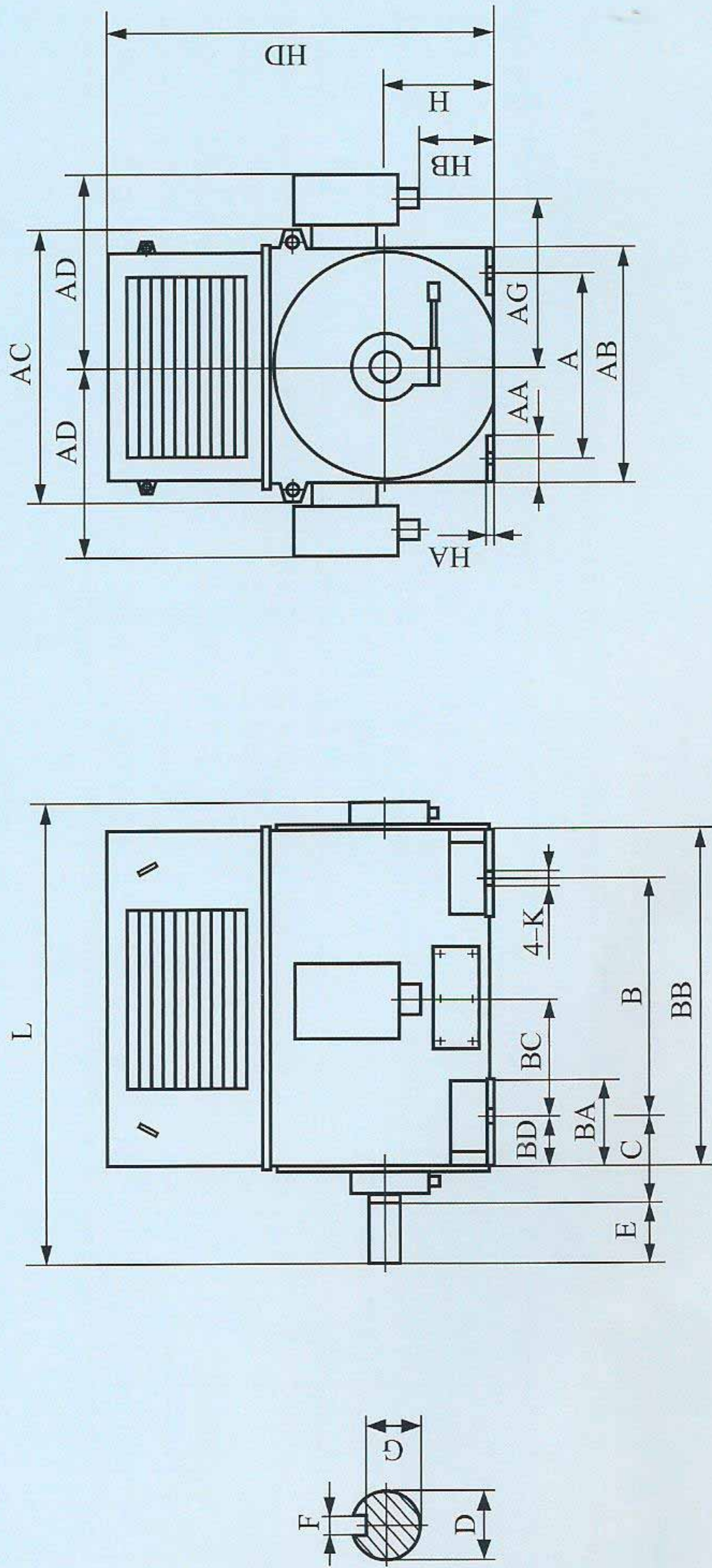

1、Y系列高压三相异步电动机（带顶罩） Y range of high-voltage three-phase induction motors (with top cover)

mm

机座号 (H) —极数 Frame sizes(H) -No. of poles	A	AA	AB	AC	AD	AG	B	BA	BB	BC	BD	C	D	E	F	G	H	HA	HB	HD	K	L
450-2	800	208	980	1180	990	660	1120	620	1620	509	301	400	90	170	25	81	450	40	140	1320	35	2000
500-2	900	208	1120	1320	1060	830	1250	660	1730	495	370	560	100	210	28	90	500	40	240	1510	42	2350
560-2	1000	210	1220	1460	1110	880	1400	720	1860	585	345	560	130	250	32	119	560	40	280	1760	42	2650
560-4	1000	210	1220	1460	1110	880	1400	720	1860	570	360	500	150	250	36	138	560	40	290	1750	42	2400
630-2	1120	210	1260	1500	1135	975	1600	670	2000	710	290	560	140	250	36	128	630	40	480	1920	48	2750
630-4	1120	210	1260	1500	1135	975	1600	670	2000	740	260	530	170	300	40	157	630	40	480	1920	48	2800
630-6-12	1120	210	1260	1500	1135	975	1600	670	2000	740	260	530	180	300	45	165	630	40	480	1920	48	2800

注：功率2000kW及以上电动机左侧带有副接线盒。

Note: For the motors of output 2000kW and more, the secondary terminal boxes are located at the left side.



外形及安装尺寸

Overall and mounting dimensions

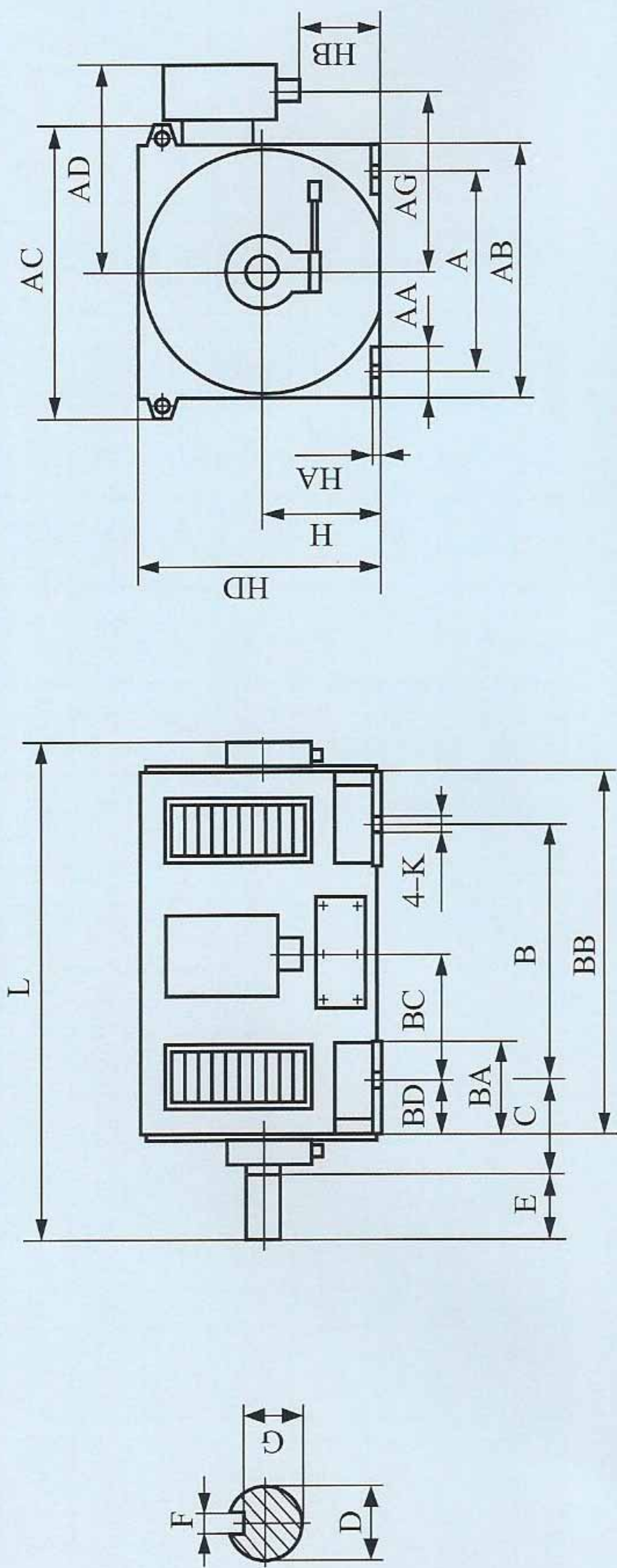

2、Y系列高压三相异步电动机（不带顶罩） Y range of high-voltage three-phase induction motors (without top cover)

机座号 (H) —极数 Frame sizes(H) —No. of poles	A	AA	AB	AC	AD	AG	B	BA	BB	BC	BD	C	D	E	F	G	H	HA	HB	HD	K	L
450-2-4-8	800	208	980	1180	990	660	1120	620	1620	548	262	355	110	210	28	100	450	40	140	950	35	2050
500-4	900	208	1120	1320	1060	830	1250	660	1730	510	355	475	120	210	32	109	500	40	240	1050	42	2200
500-6-12	900	208	1120	1320	1060	830	1250	660	1730	510	355	475	130	250	32	119	500	40	240	1050	42	2200
560-6-12	1000	210	1220	1460	1110	880	1400	720	1860	570	360	500	160	300	40	147	560	40	290	1180	42	2450



外形及安装尺寸

Overall and mounting dimensions

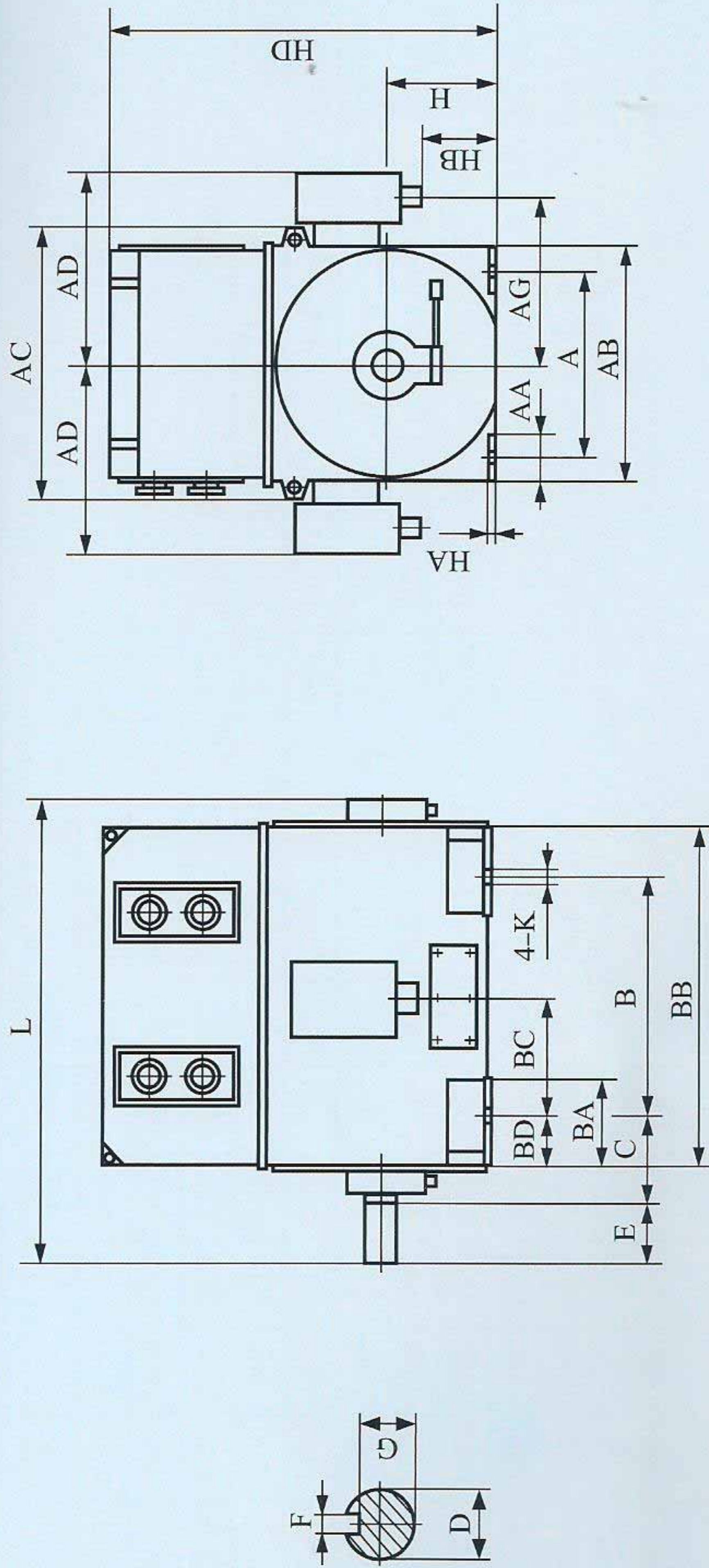

3、YKS系列高压三相异步电动机

YKS range of high-voltage three-phase induction motors

机座号 (H) —极数 Frame sizes(H) —No. of poles	A	AA	AB	AC	AD	AG	B	BA	BB	BC	BD	C	D	E	F	G	H	HA	HB	HD	K	L
450-2	800	208	980	1180	990	660	1120	620	1620	509	301	400	90	170	25	81	450	40	140	1930	35	2000
450-4-8	800	208	980	1180	990	660	1120	620	1620	548	262	355	110	210	28	100	450	40	140	1930	35	2050
500-2	900	208	1120	1320	1060	830	1250	660	1730	495	370	560	100	210	28	90	500	40	240	2080	42	2350
500-4	900	208	1120	1320	1060	830	1250	660	1730	510	355	475	120	210	32	109	500	40	240	2080	42	2200
500-6-12	900	208	1120	1320	1060	830	1250	660	1730	510	355	475	130	250	32	119	500	40	240	2080	42	2200
560-2	1000	210	1220	1460	1110	880	1400	720	1860	585	345	560	130	250	32	119	560	40	280	2330	42	2650
560-4	1000	210	1220	1460	1110	880	1400	720	1860	570	360	500	150	250	36	138	560	40	290	2330	42	2400
560-6-12	1000	210	1220	1460	1110	880	1400	720	1860	570	360	500	160	300	40	147	560	40	290	2330	48	2450
630-2	1120	210	1260	1500	1135	975	1600	670	2000	710	290	560	140	250	36	128	630	40	480	2850	48	2750
630-4	1120	210	1260	1500	1135	975	1600	670	2000	740	260	530	170	300	40	157	630	40	480	2850	48	2800
630-6-12	1120	210	1260	1500	1135	975	1600	670	2000	740	260	530	180	300	45	165	630	40	480	2850	48	2800

注：功率2000kW及以上电动机左侧带有副接线盒。

Note: For the motors of output 2000kW and more, the secondary terminal boxes are located at the left side.



外形及安装尺寸

Overall and mounting dimensions

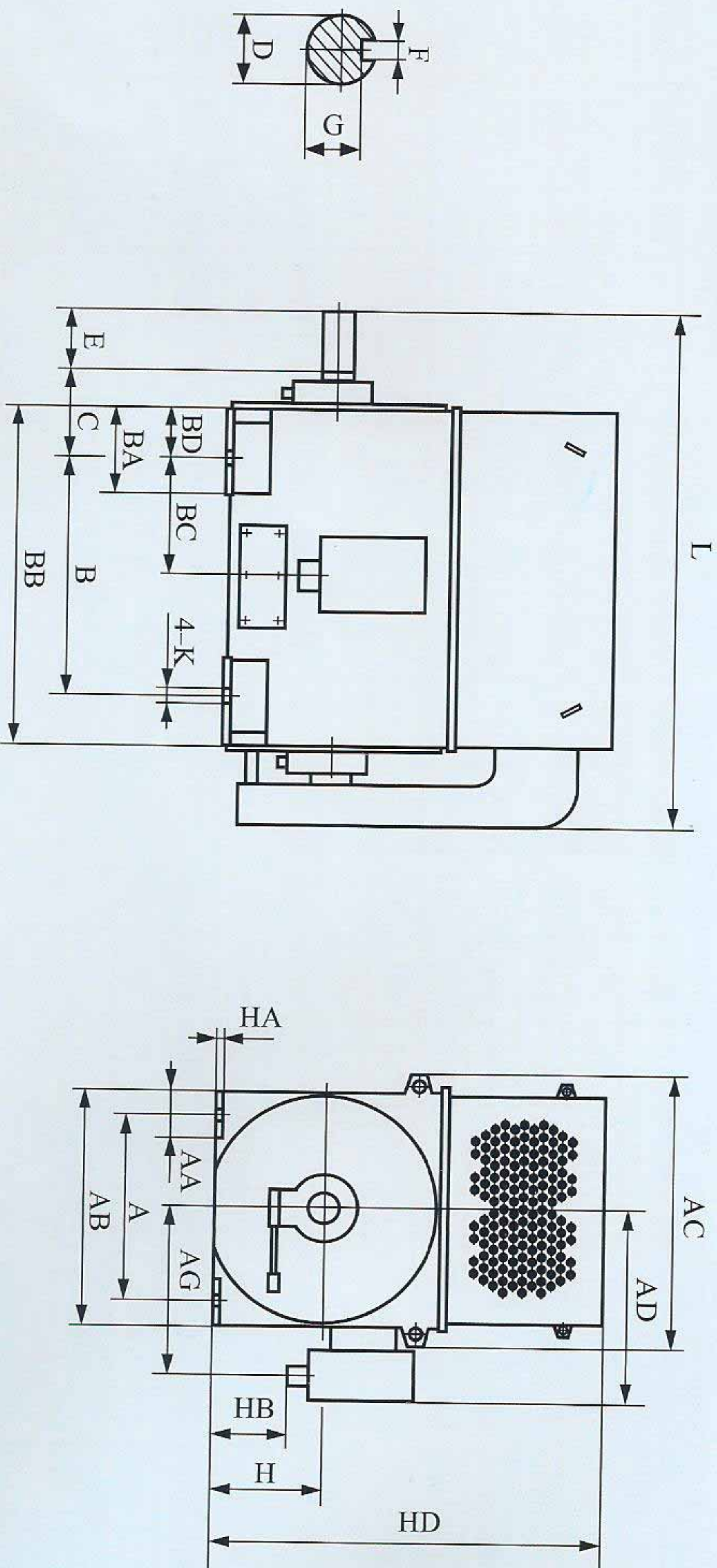

4、YKK系列高压三相异步电动机

YKK range of high-voltage three-phase induction motors

机座号 (H) —极数 Frame sizes(H) -No.of poles	A	AA	AB	AC	AD	AG	B	BA	BB	BC	BD	C	D	E	F	G	H	HA	HB	HD	K	L
450-2	800	208	980	1180	990	760	1120	695	1620	509	301	400	90	170	25	81	450	40	140	1660	35	2300
450-4-6	800	208	980	1180	990	760	1120	695	1620	548	262	355	110	210	28	100	450	40	140	1660	35	2350
500-2	900	208	1120	1320	1060	830	1250	660	1730	495	370	560	100	210	28	90	500	40	240	1850	42	2650
500-4	900	208	1120	1320	1060	830	1250	660	1730	510	355	475	120	210	32	109	500	40	240	1850	42	2500
500-6-10	900	208	1120	1320	1060	830	1250	660	1730	510	355	475	130	250	32	119	500	40	240	1850	42	2600
560-2	1000	210	1220	1460	1110	880	1400	720	1860	585	345	560	130	250	32	119	560	40	280	2125	42	2800
560-4	1000	210	1220	1460	1110	880	1400	720	1860	570	360	500	150	250	36	138	560	40	290	2125	42	2700
560-6-12	1000	210	1220	1460	1110	880	1400	720	1860	570	360	500	160	300	40	147	560	40	290	2125	42	2700
630-2	1120	210	1260	1500	1135	975	1600	670	2000	710	290	560	140	250	36	128	630	40	480	2250	48	3300
630-4	1120	210	1260	1500	1135	975	1600	670	2000	740	260	530	170	300	40	157	630	40	480	2250	48	3200
630-6-12	1120	210	1260	1500	1135	975	1600	670	2000	740	260	530	180	300	45	165	630	40	480	2250	48	3300

注：功率2000kW及以上电动机左侧带有副接线盒。

Note: For the motors of output 2000kW and more, the secondary terminal boxes are located at the left side.



SINOPEC 市场成员证书



CNPC 认证证书

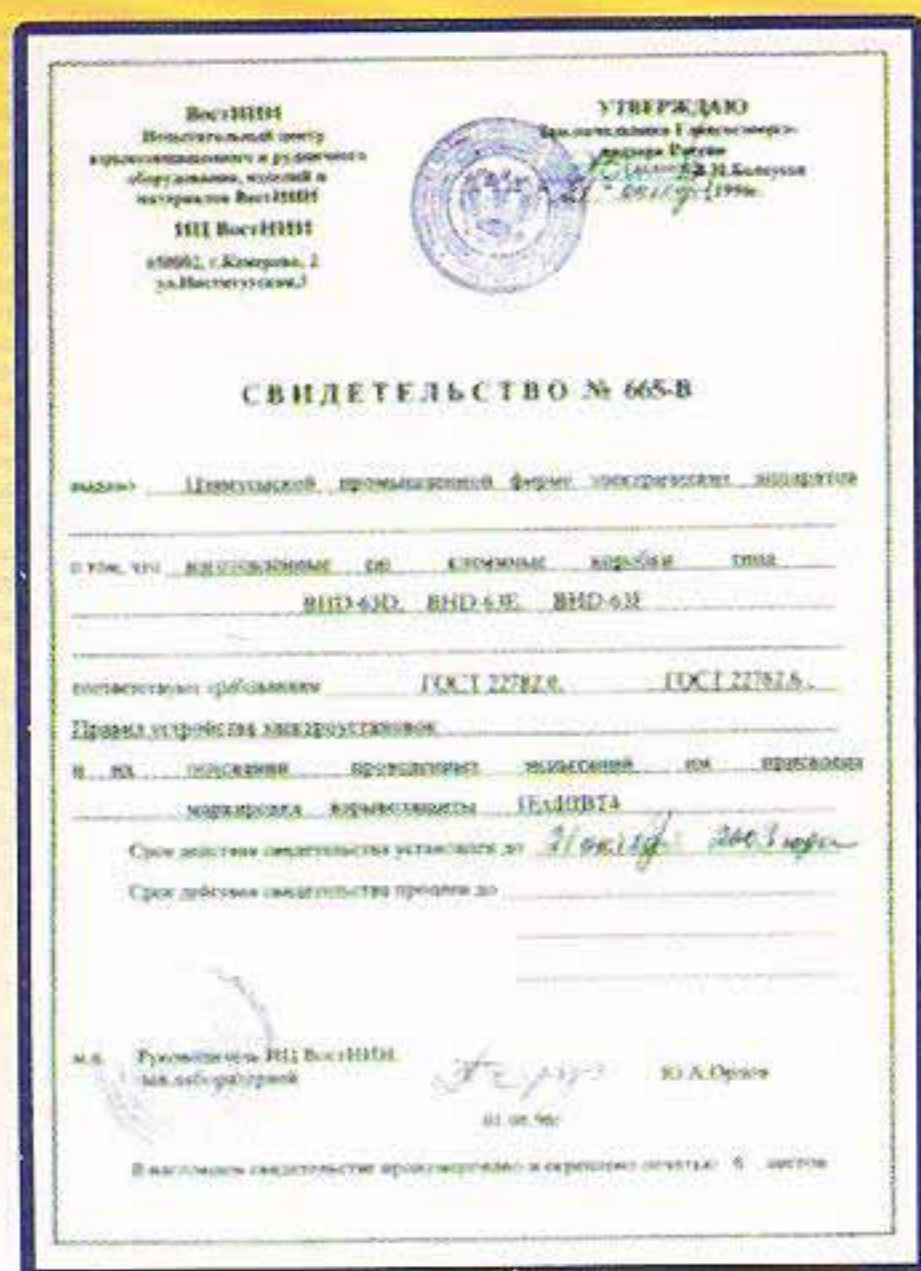

俄罗斯防爆产品认证证书



MA 安标产品证书



ISO9001:2000 认证证书

D 订货须知

Ordering information

1) 请在订货时注明以下参数(示例)

型 号: Y4502-2

安装方式: IMB3

额定功率: 250KW

极 数: 2

防护等级: IP23

额定电压: 10000V

冷却方式: IC01

额定频率: 50HZ

环境条件: 海拔 < 1000m, +40℃

旋转方向: 顺时针(轴伸端视之)

出线盒位置: 电机右侧(轴伸端视之)

2) 本系列电动机根据用户需要装设定子测温装置, 均采用Pt100铂热电阻(0℃时为100Ω), 请订货时提出。

3) 电动机可根据用户需要加装加热器, 轴承测温装置, 请在订货时提出。

4) 若配套机械为通风机或磨煤机等, 订货前请告知该机械的转动惯量(J)或飞轮力矩GD2阻力矩, 可另订技术协议。

5) 其他特殊产品, 订货时可另订技术协议。

*本样本提供用户选型参考, 外形尺寸可能有所变动, 订货时请与本公司联系确认。



▲航空母舰

中国·佳木斯防爆电机有限公司

JIAMUSI EXPLOSION-PROOF ELECTRIC MOTOR CO.,LTD

厂址：中国黑龙江省佳木斯市东风区建国街418号

电话：(0454) 8337673 (0454) 8337213

传真：(0454) 8337750

邮编：154005